

TS

STATE-OF-THE-ART TECHNOLOGY FOR A HIGH PERFORMANCE THREE-PHASE UPS

10 kVA – 80 kVA

Its power factor of 1 (kW = kVA) and easy maintenance reduce system TCO, making TS the best choice for data centres.



IDEAL FOR



FEATURES

- The patented GLM function can reuse energy regenerated by the loads, ensuring maximum efficiency when managing regenerative loads.
- Optimised footprint for maximum installation versatility.
- Designed to minimise impact on generators and avoid the need for overdimensioning them.
- Power factor of 1 kW = kVA: maximum active power available for your system at all times.
- Fail-safe: the UPS indicates when the phase sequence is connected incorrectly without interrupting the supply from the inverter to the loads, while keeping the batteries charged.
- Up to 6 units can be connected in parallel for power or redundancy.
- Long component life for a lower TCO (Total Owner of Ownership): the Energy Saver function automatically makes the power modules work in rotation, also guaranteeing greater efficiency.
- Dual input and internal manual bypass.
- High overload capacity for up to 3 seconds at 300% load.
- High-performance battery charger for fast and efficient battery charging.
- Variable battery configuration can be set from the LCD.
- Compatible with lithium-ion batteries or other technologies.
- Smart battery discharge test without the need for external loads.
- Real-time battery disconnection alarm.
- Cold start (up to 20 kVA standard, up to 80 kVA optional).
- Separate or common batteries that can be configured for parallel systems.
- Wide range of communication options included: two ports as standard (RS-485 ModBus and USB), programmable dry contacts plus two additional slots for optional cards.
- 4.3" colour LCD touch screen display for user-friendly interface (14 selectable languages).
- UPS information, settings and log files can be downloaded to a removable SD card.

KEY OPTIONS

- SNMP, RS-485 ModBus card.
- Parallel kit.
- Removable internal battery compartments for easy battery maintenance.
- Internal isolation transformer (up to 40 kVA).
- External temperature sensor for a battery cabinet.
- Touch panel for remotely monitoring up to 64 units.
- Internal backfeed contactor.



EXCLUSIVE ADVANCED FEATURES

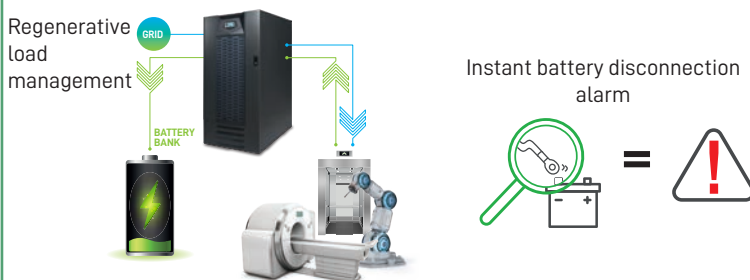

IDEAL FOR GENERATORS

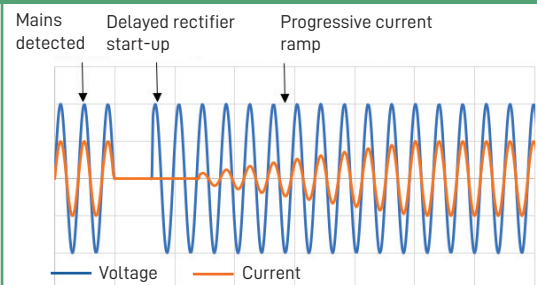

TS TECHNICAL DATA SHEET

MODEL		TS10	TS20	TS30	TS40	TS60	TS80
POWER	kVA	10	20	30	40	60	80
	kW	10	20	30	40	60	80
INPUT	Rated voltage	400 V three-phase with neutral					
	Voltage tolerance	±20% @100% load, -40/+20% @50% load					
	Rated frequency	40 – 70 Hz					
	Power factor	≥0.99					
	Current distortion (THDi)	<3%					
OUTPUT	Rated voltage	380/400/415 V three-phase+neutral					
	Voltage stability	±1% (static load)					
	Frequency	50/60 Hz					
	Frequency stability	±0.01% (free running)					
	Power factor	1					
	Crest factor	3:1					
	Voltage distortion	<1% with linear load, <3% with distorting load					
	Overload	110% for 60 minutes, 125% for 10 minutes, 150% for 1 minute, >150% and <300 for 3 seconds					
BATTERY	Number per string (12V)	26-40 configurable	32-40 configurable				
	Max. charging current *	10 A	21 A	30 A	39 A	60 A	78 A
	Common battery for parallel configuration	Supported					
	Battery internal	Up to 2 battery strings 7/9Ah (max 80)				N.A	
EFFICIENCY	VFI mode	Up to 96%					
	ECO mode	Up to 98%					
	In battery	Up to 94.5%					
BYPASS	Rated voltage	380/400/415 V three-phase+neutral					
	Voltage tolerance	±5%–±25% (programmable alarm)					
	Frequency	50/60 Hz					
	Frequency tolerance	±1 Hz/±3 Hz (selectable)					
GENERAL	Parallel connection	Up to 6 units					
	Dimensions (WxDxH) mm	440x860x1390				600x827x1300	
	Weight (kg)	84	86	130	132	200	210
	Protection class	IP20					
CONNECTIVITY	User interface	4.3" colour LCD touch screen display with removable SD card					
	Built-in communication ports	USB, RS232, EPO, 1 in/3 out dry relay contacts (programmable) and additional slots for optional cards					
	Optional accessories	Cards: SNMP, RS-485 ModBus, 6 in/6 out dry relay contacts (programmable), touch panel for remote monitoring of up to 64 units					
ENVIRONMENTAL PARAMETERS	Operating temperature**	0-40°C					
	Relative humidity	0-95% (non-condensing)					
	Altitude (a.s.l.)	<1000 m with no power derating, >1000 m with 1% derating for every 100 m.					
	Audible noise at 1 m.	<52 dBA		<55 dBA		<60 dBA	
REGULATIONS	Standards	IEC EN 62040-1, IEC EN 62040-2, IEC EN 62040-3					
	Marking	CE					

Specifications subject to change without notice - Rev. 22.09

* Subject to conditions

** To be verified according to the battery parameters